

Schlüter®-DECO-SG

Wall corners and edge profiles
for decorative wall design

2.16

Product data sheet

Application and function

Schlüter-DECO-SG is a high-quality, decorative profile made of brushed stainless steel (V4A) or anodised aluminium for joint design in tile coverings. It forms a shadow joint in a width of 12 or 15 mm that allows for creating particularly appealing interior wall coverings.

Due to its U-shaped geometry, the profile is ideally suited for the insertion of glass elements in floor and wall areas in conjunction with floor-level showers.

In floor areas, Schlüter-DECO-SG forms a functional and decorative solution in combination with the tapered profiles Schlüter-SHOWERPROFILE-S.

Note: The illumination set **Schlüter-LIPROTEC-LLPM** is a pre-assembled LED module made from a flexible, encapsulated LED strip with homogeneous light distribution and DECO-SG as a receptacle profile (see product data sheet 15.8 Schlüter-LIPROTEC-LLPM/-LLP/-LLPE).

Material

Schlüter-DECO-SG is available in the following material version:

AE = anodised aluminium
EB = brushed stainless steel 1.4404 (V4A) Material no. 1.4404 = AISI 316L



Material properties and areas of application:

In special cases, the suitability of the material type must be verified based on the anticipated chemical, mechanical, and/or other stresses. The information provided below is intended as a general guideline.

Anodised aluminium: The aluminium features an anodised finish that retains a uniform appearance during normal use. Surface areas must be protected against abrasion or scratching. Aluminium is sensitive to alkaline media. Cementitious materials, in conjunction with moisture, become alkaline. Depending on the concentration and duration of exposure, this may result in corrosion (aluminium hydroxide formation).

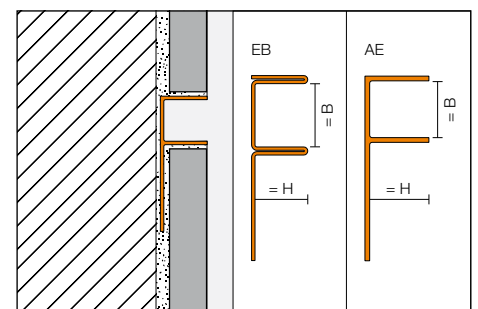
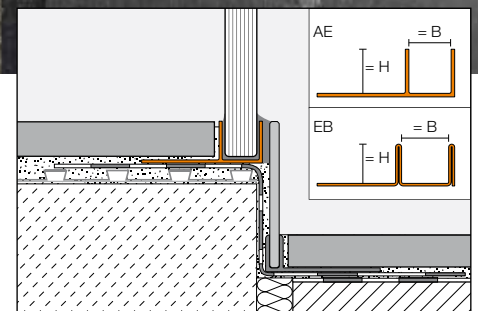



Installation in shower with glass element



Installation in skirting



Installation as a shadow joint in the wall area



Installation as accent lighting with LED module LIPROTEC-LLPM

For this reason, remove adhesive or grouting material immediately from all visible areas and do not cover freshly installed coverings with foil. In addition, ensure that the profile is solidly embedded in the setting material to prevent water from accumulating in small cavities.

Stainless steel: Stainless steel can withstand high mechanical stress and is highly resistant against chemicals. Even stainless steel of quality 1.4404 is not resistant to all chemical stresses. Substances such as hydrochloric or hydrofluoric acid or certain chloride and brine concentrations may cause damage. Consideration of anticipated chemical stresses should therefore be verified in advance.

Installation

1. Select Schlüter-DECO-SG according to the tile thickness.
2. Apply tile adhesive to the area where the tile covering will end, using a notched trowel.
3. Press the trapezoid-perforated anchoring leg of Schlüter-DECO-SG firmly into the adhesive and align it.
4. Trowel additional tile adhesive over the perforated anchoring leg to ensure full coverage.
5. Firmly press the adjoining tiles into place and align them in such a way that they are flush with the upper profile edge. The tiles must be fully embedded in the area of the profile.
6. Leave a joint of approx. 1.5 mm between the tile and the profile. Completely fill the space between the tile and the profile with grout.
7. Use suitable materials and tools for the sensitive surfaces to avoid scratches or other damage. Residue of mortar and tile adhesive should be removed immediately.
8. Glass elements may be inserted into Schlüter-DECO-SG after the final installation.

Important: The glass may not be in direct contact with the profile. Use suitable spacers and seal the joints with silicone.

Product overview:

Schlüter®-DECO-SG

AE = anodised aluminium/EB = brushed stainless steel
1.4404 (V4A) Supplied length: 2.50 m

H = mm	8	10	11	12.5
AE 12	•	•	•	•
AE 15	•	•	•	•
EB 12	•	•	•	•
EB 15	•	•	•	•

Notes

Schlüter-DECO-SG requires no special maintenance or care. Do not use abrasive cleaning agents on sensitive areas. Damaged anodised surfaces can be restored with paint.

Regularly treat stainless steel surfaces with a polish such as Schlüter-CLEAN-CP to retain their shine.

Text template for tenders:

_____linear metres of Schlüter-DECO-SG, both as a decorative shadow joint profile in tile coverings with trapezoid perforated anchoring leg or as a profile for the attachment of glass elements in floor and wall areas, to be supplied and professionally installed according to manufacturer's specifications.

Material:

AE = anodised aluminium

EB = brushed stainless steel 1.4404 (V4A)

Profile height: _____ mm

Joint width _____ mm

Art.-No.: _____

Material: _____/m

Labour: _____/m

Total: _____/m